

50-K-54 - SPEEDLINE System Data Sheet - Version V1 (24-10-23)

SPEEDLINE 50mm 'C' Stud Partition @600mm Ctrs,
with Knauf 15mm Soundshield Plus each side

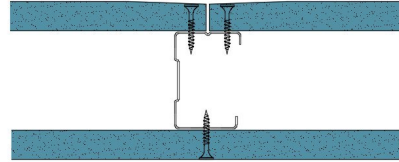

System Performance Breakdown

Fire Resistance:

BS476 Part 22:1987:

Test Ref & Date or Applied Ref & Report:

Max Height:

Thickness:

Duty Grade: BS 5234: Part 2:1992:

Sound Insulation:

30/30 Minutes (Integrity/Insulation).

BTC 17436F - BRE Report P102396-1011B

Refer to Speedline Specification Clause

82 mm. (At Base Track, Excluding Finishes)

Severe - Annexes A-F

38 R_w dB, Date Tested or Assessed Against - 22/06/2011

Test Code:
H17415AA
Test Date:
22/06/2011

Freq. Hz	R dB
50	22.3
63	18.5
80	14.0
100	13.4
125	13.9
160	22.9
200	29.0
250	30.7
315	31.6
400	38.4
500	43.3
630	46.2
800	51.6
1 000	53.3
1 250	54.4
1 600	50.6
2 000	39.7
2 500	37.7
3 150	42.5
4 000	46.9
5 000	48.3
6 300	
8 000	
10 000	

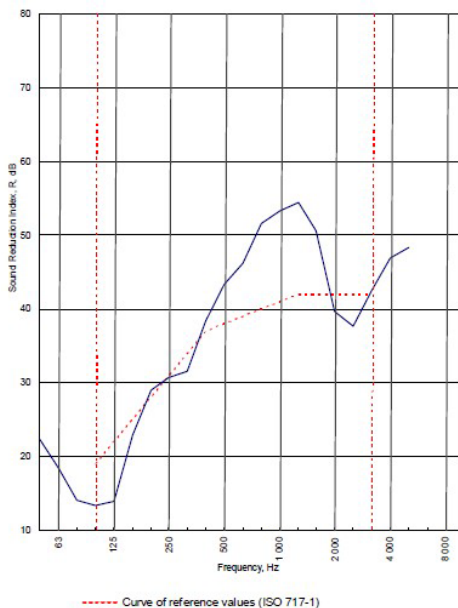

Rating according to BS EN ISO 717-1:1997	R_w (C;Ctr) = 38 (-2;-8) dB		
Evaluation based on laboratory measurement results obtained by an engineering method:	$C_{50-3150} = -3$ dB	$C_{50-5000} = -2$ dB	$C_{100-6300} = -1$ dB
	$C_{50-3150} = -10$ dB	$C_{50-4000} = -10$ dB	$C_{50-4000} = -8$ dB

TESTED AT ONE OF THE UKAS ACCREDITED LABORATORIES BELOW

B.T.C (H-Ref on Graph)

B.R.E

AIRO

S.R.L

Customer: Metsec plc Hepsec Division

BTC 17415A: Page 8 of 10

